

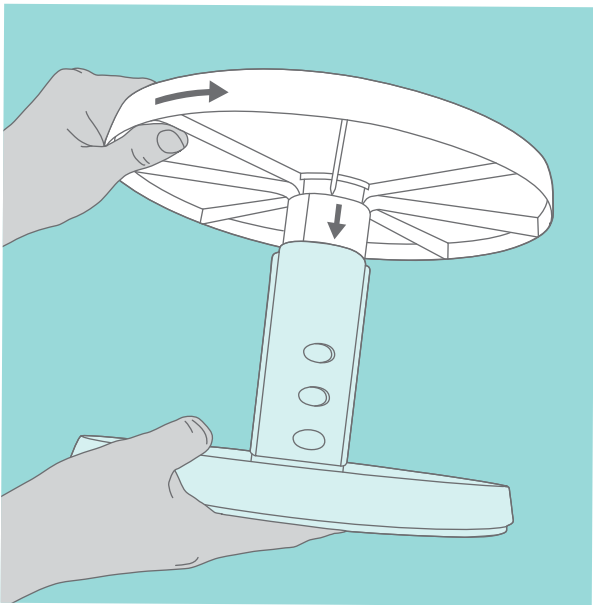

1. Set the lower tray on a flat surface. Place center tube in the middle of the tray so pins sit in holes. Twist center tube counter-clockwise (right) to lock in place.

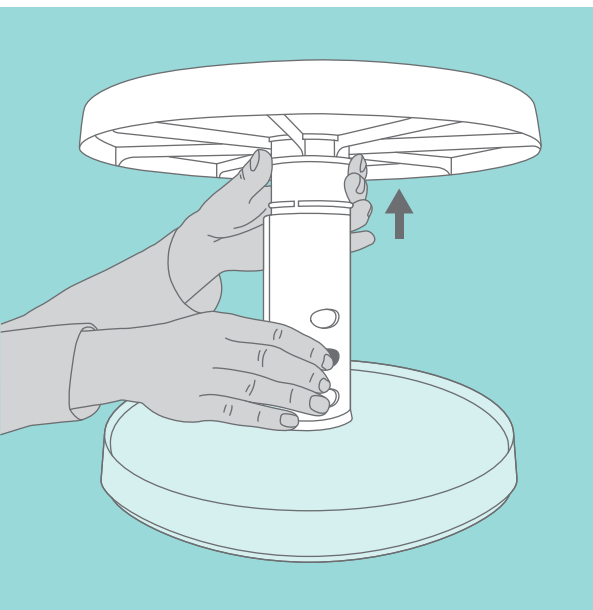

2. Place top tray on center tube so pins sit in holes. Twist center tube clockwise (left) to lock into place.



3. To adjust height, press buttons on both sides of center tube and lift top tray from underneath (center) until buttons click into place.